

# BORE GAUGE SETTER



2440-290



2440-510

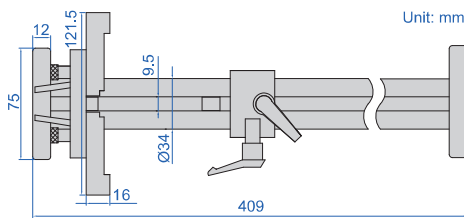

2440-290

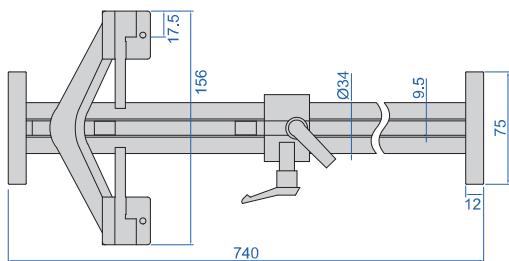

2440-510

### measuring principle

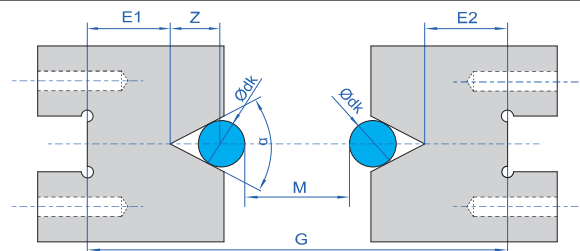

calculation formula:  $\sin\alpha/2=r/Z$   
 $Z=r/(\sin\alpha/2)$   
 $G=E1+E2+2*Z+dk+M$

$\alpha$ : V-groove angle  
 $\text{Ødk}$ : ball diameter  
 $M$ : distance between pins  
 $Z$ : distance from ball center to V-groove top  
 $E1/E2$ : distance from V-groove top to the fixed edge  
 $r$ : ball radius

- Dual-purpose for vertical and horizontal use
- Used together with gauge blocks to set bore gauges
- Used together with V-blocks to set gear bore gauges
- Can be used with **2424** blind-hole bore gauges, **2433** internal groove bore gauges, **2921** rotary bore gauges, **2428** gear bore gauges
- **2440-510** also applies to bore gauge **2422-510**

### application (setting bore gauge)

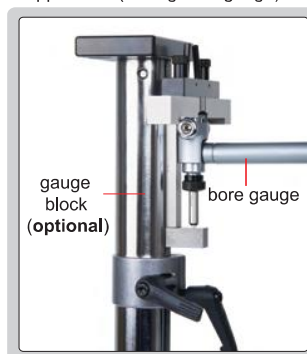

### can be used vertically



### application (setting gear bore gauge)

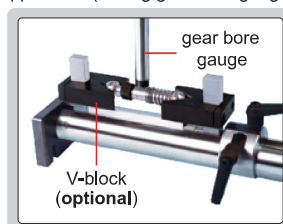

Code	Setting range	Setting accuracy (without gauge block)
2440-290	18-290mm	2µm
2440-510	160-510mm	2µm

### V-block

Code	Remark
2440-V□□□□□	Customized according to the workpiece